



Artist impression

St Paul's Cemetery

Carlingford Memorial Garden Information

St Paul's | REAL
Anglican | HOPE
JESUS



A new chapter for the St Paul's Cemetery

For more than 170 years, St Paul's Anglican Carlingford has cared for its parish cemetery, the final resting place for generations of St Paul's parishioners and many of the Parramatta district's pioneering families.

Nestled between private homes, Simpson Reserve, and the former Swanes nursery off Marsden Road, this historic cemetery sits not far from the original St Paul's church building. The land was granted to St Paul's in 1847 by local farming identity William Mobbs Jr. who became the first person laid to rest there in July 1851.

The St Paul's Cemetery has been in continual operation since that time and is now entering a new chapter.

St Paul's is currently revitalising the cemetery so this hidden historical gem can continue to fulfil the purpose for which it was originally established. The new memorial garden offers an updated option for burials and the interment of ashes for both St Paul's parishioners and the wider community.

Cemetery renewal progress

We engaged a landscape architect to develop a master plan for the cemetery, and landscape engineers have now completed the building plans. Phase 1 includes removing invasive weed trees and revitalising the bright, sunny north-east corner of the cemetery with a new memorial garden.

With council approval in place, construction is about to begin. The new garden will feature accessible pathways, new tree plantings, garden beds, seating, and several options for the interment of ashes. Full casket burials will also be available.

A number of St Paul's parishioners have already pre-purchased places for their own future use or for family members. We are now ready to accept further purchases of ash-interment and burial options from St Paul's parishioners, and to begin promoting the cemetery to others connected with St Paul's and to the wider local community.

Artist impression

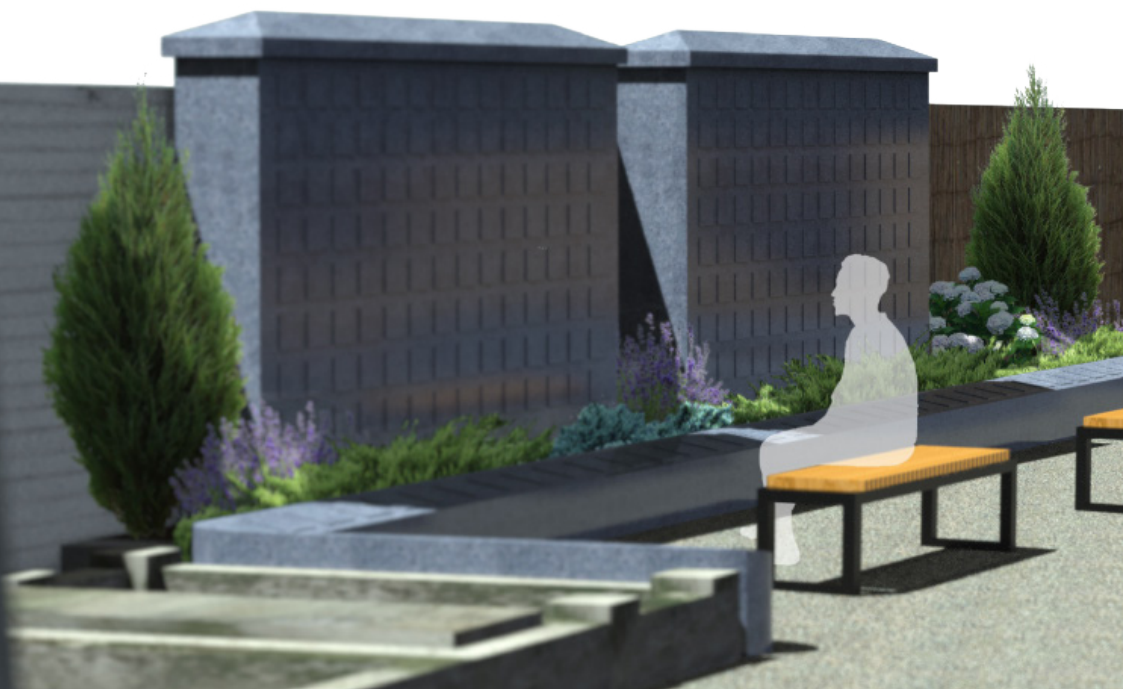

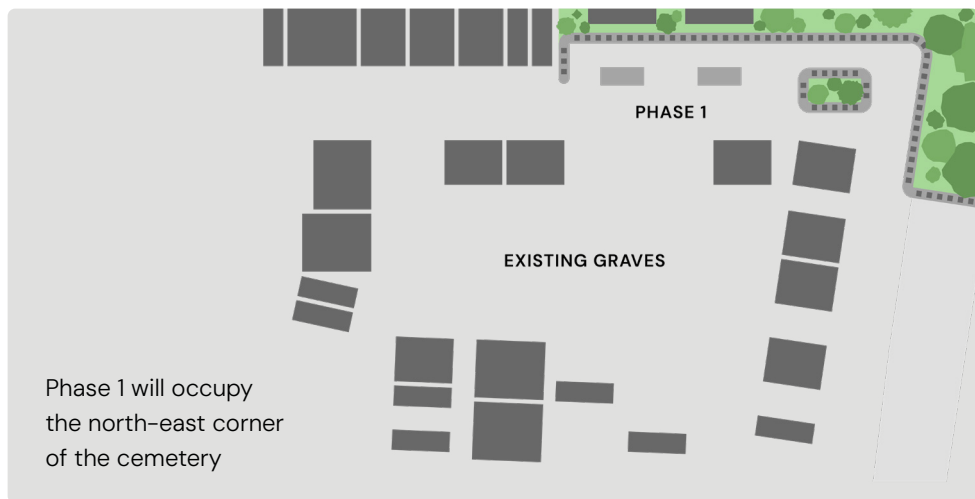

Artist impression



Pricing for interment options



Memorial wall

\$2,950*



Garden edge

\$3,850*



Dual cylinder

\$9,950*



Burial plot

\$11,950*

***St Paul's Carlingford church members receive a 5% discount on all purchases.**

Please note: the above fees are for the niche or burial plot only and are GST inclusive. This price includes purchase of the niche or burial plot which includes perpetual interment rights and ongoing upkeep and maintenance of the cemetery site. The provision of additional services such as cremation, an engraved plaque, interment of ashes, headstone, excavation, casket, and other costs associated with a funeral service, are additional and arranged via a funeral service provider in conjunction with the St Paul's office, at the time of need. All interments must be conducted with a Christian funeral service.



To indicate your interest, please complete the expression of interest form below and return it to the St Paul's office. Alternatively, visit stpa.org.au/cemetery or scan the QR code to complete the form online.

Expression of interest form

First name:

Last name:

Email:

Phone number:

☐ I would like to learn more

☐ I intend to purchase

I am interested in purchasing:

☐ Memorial wall – \$2,950*

Amount: _____

☐ Garden edge memorial – \$3,850*

Amount: _____

☐ Dual cylinder – \$9,950*

Amount: _____

☐ Burial plot – \$11,950*

Amount: _____

*St Paul's Carlingford church members receive a 5% discount on all purchases.

Completing this form only indicates your interest in purchasing and is not at all binding.

When this form has been submitted, a cemetery representative will contact you to answer any questions, confirm your purchase intentions, and provide the financial and legal documents required to make your decision.

For any questions or further information, please contact St Paul's during office hours to speak with a cemetery representative, or send us an email.

Phone: 02 9871 6077

St Paul's Anglican Church

Email: cemetery@stpaulsanglican.org.au

32 Moseley St, Carlingford NSW